

NOTE: BREAK ALL CORNERS WITH 0.015" (.38 MM) RADIUS UNLESS OTHERWISE NOTED. STANDARD TOLERANCES TO APPLY UNLESS OTHERWISE SPECIFIED.

| | | |
|--|-------------------------------|--------------------------------|
| CUSTOMER CAN ART STD. | DIE No. EH05985 | REV. No. 1 |
| DESCRIPTION 3.500 x 1.000 x 0.070 RECT. TUBE | CUSTOMER PART No. | PROPOSAL No. H-24410 |
| | QUOTE No. 11-0510-1 | |

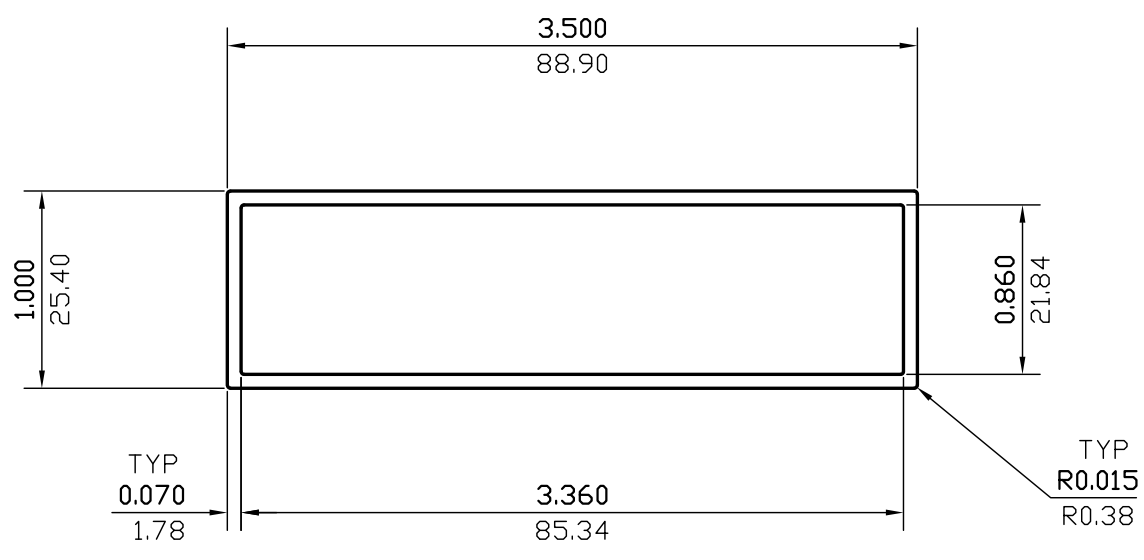

WALL THICKNESS 0.070 (1.78) EXCEPT AS SHOWN

| DATE | REV | DESCRIPTION | BY |
|----------|-----------|------------------|-----------------------------|
| 03/14/23 | 1 | REMOVED ALLOY | JASON |
| EST.AREA | 0.610 | IN. ² | EST.AREA 393.809 |
| | | | MM. ² |
| EST.WT. | 0.720 | LBS/FT. | EST.WT. 1.072 |
| | | | KG/M. |
| EST.PER. | 17.388 | IN. | EST.PER. 441.668 |
| | | | MM. |
| OUT PER. | 8.974 | IN. | OUT PER. 227.9 |
| | | | MM. |
| C.C.D. | 3.632 | IN. | C.C.D. 92.251 |
| | | | MM. |
| FINISH | M/F | | ALLOY |
| CKD BY | FACTOR 24 | SCALE 1:1 | DWN BY P.M. DATE 05/30/2011 |

CAN ART

ALUMINUM EXTRUSION INC.

85 PARKSHORE DRIVE
BRAMPTON, ONT L6T 5M1
TEL. NO. (905) 791-1464
FAX NO. (905) 791-9151
WEB: www.canart.com

THIS DRAWING IS NOT NECESSARILY A COPY OF YOUR ORIGINAL. PLEASE APPROVE DIMENSIONS AND TOLERANCES INDICATED. CAN ART ASSUMES NO RESPONSIBILITY EITHER TECHNICAL OR LEGAL FOR HAVING THIS SHAPE MADE. THE CUSTOMER AGREES TO FULLY PROTECT CAN ART ALUMINUM FROM CLAIMS OF OTHERS RESULTING FROM THIS SHAPE.

SIGNED: _____ DATE: _____